

2717 Monobolt

Dome head · Stainless steel 316 body · Stainless steel 316 stem · Multi-grip
4.8 mm (3/16") - 6.4 mm (1/4")

Features

- Multi-grip structural breakstem fastener
- Fully sealed joint and visible lock for quick and easy inspection
- Corrosion resistant, suitable for applications in marine and hostile environments
- Excellent hole fill via radially expanded body provides very strong, vibration resistant joints and compensates for irregular, oversized, slotted or misaligned holes
- Good sheet take-up performance for large gap closing capability
- Stem mechanically locked into body avoids damage, electrical problems or rattling caused by loose stems
- High shear and tensile strength

Material

- Body: Stainless steel 316, natural
- Stem: Stainless steel 316, natural

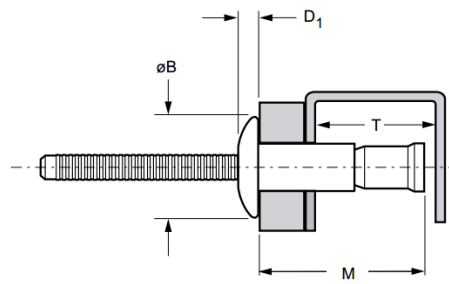
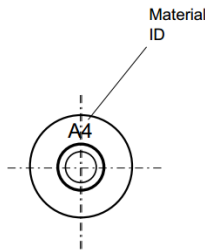

Before Placement

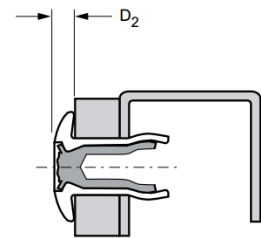

After Placement

| Part No. | Size ø | Grip Range | | Hole Size | | M | øB | D ₁ | T | D ₂ | Shear (typical) kN | Tension (typical) kN |
|-------------|----------------|------------|-------|-----------|------|------|------|----------------|------|----------------|--------------------------|----------------------------|
| | | nom. | min. | max. | min. | | | | | | | |
| 02717-00613 | 4.8 (3/16") | 1.63 | 6.86 | 4.9 | 5.1 | 18.2 | 10.1 | 2.1 | 10.5 | 1.9 | 6.45 | 5.11 |
| 02717-00617 | | 1.63 | 11.10 | | | 24.5 | | | 13.5 | | | |
| 02717-00817 | 6.4 (1/4") | 2.03 | 9.53 | 6.6 | 7.0 | 23.7 | 13.4 | 2.9 | 12.2 | 2.7 | 13.20 | 10.45 |
| 02717-00824 | | 2.03 | 15.87 | | | 33.0 | | | 16.4 | | | |



Can't find what you are looking for?

We can provide customized finishing and colouring.
Contact your nearest [Gripwell](#) team for assistance!