

Stainless Steel 304

Large Flange
Semi-Hexagonal Shank
Open End

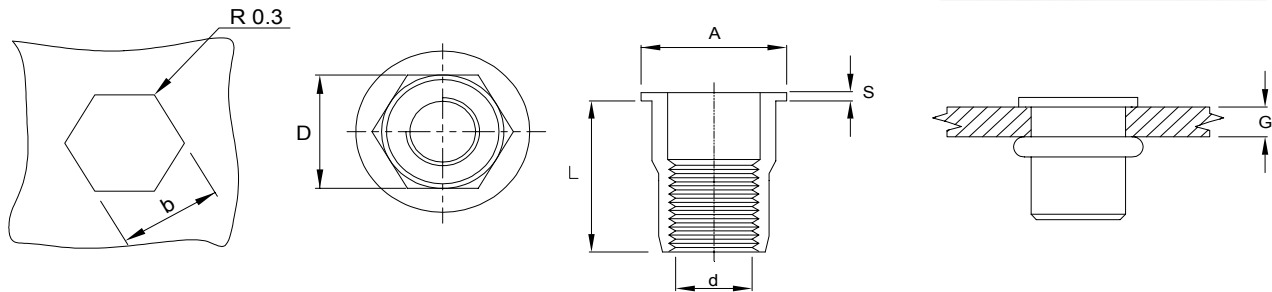

THREAD SIZE (d)	GRIP RANGE (G)		HEX HOLE (b) (+0.1)	PART NUMBER	HEX BODY (D)	OVERALL LENGTH (L)	FLANGE DIAMETER (A)	LIP THICKNESS (S)
	min.	max.						
M4	0.5	2.0	6.0	G44 500	6.0	11.0	9.0	1.0
M5	0.5	3.0	7.0	G45 500	7.0	11.5	10.0	1.0
M6	0.5	3.0	9.0	G46 460	9.0	14.5	12.0	1.5
M8	0.5	3.0	11.0	G48 250	11.0	16.0	15.0	1.5

Dimensions in millimetres

Other sizes available, please contact our Sales Engineers.

Gripwell Fastening & Engineering Pte Ltd

10 Upper Aljunied Link, #03-03, York Int'l. Bldg. Singapore 367904

Tel: (65) 6289 6011 Fax: (65) 6280 7877

Email : gripwell@singnet.com.sg

Website : <http://www.gripwell.com.sg>

Gripwell Malaysia:

Kuala Lumpur Office:

Email : gripwell@po.jaring.my

Tel: (603) 5511 3393 Fax: (603) 5511 3382

Gripwell Thailand:

Bangkok Office:

Email : gripwell@ksc.th.com

Tel: (662) 713 7612 Fax : (662) 719 5003

Gripwell Indonesia:

Jakarta Rep. Office

Email : gripwell@cbn.net.id

Tel: (6221) 588 2802 Fax: (6221) 588 2803